

Forskrüninger



Hofstads %



Nipler

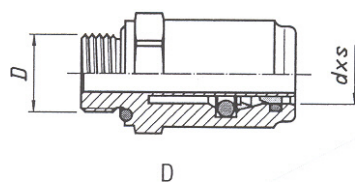

dxs = rørdim.	D	Best. nr.
6 x 1	M 12 x 1,5	4100916
6 x 1	M 14 x 1,5	4100918
6 x 1	M 16 x 1,5	4100919
8 x 1	M 12 x 1,5	4100888
8 x 1	M 14 x 1,5	4100912
8 x 1	M 16 x 1,5	4100911
8 x 1	M 22 x 1,5	4100913
10 x 1	M 12 x 1,5	4101235
10 x 1	M 14 x 1,5	4101236
10 x 1	M 16 x 1,5	4101237
10 x 1	M 22 x 1,5	4101238
10 x 1,5	M 12 x 1,5	4100908
10 x 1,5	M 14 X 1,5	4100909
10 X 1,5	M 16 x 1,5	4100907
10 x 1,5	M 22 x 1,5	4100910
12 x 1,5	M 16 x 1,5	4100915
12 x 1,5	M 22 x 1,5	4100914
15 x 1,5	M 16 x 1,5	4101055
15 x 1,5	M 22 x 1,5	4101056
16 x 2	M 16 x 1,5	4100964
16 x 2	M 22 x 1,5	4200965
18 x 2	M 22 x 1,5	410980

Rørskjøter

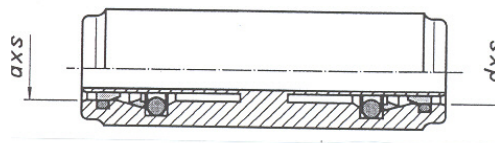

dxs = rørdim.	Best. nr.
6 x 1	4101063
8 x 1	4101064
10 x 1	4101233
10 x 1,5	4101123
12 x 1,5	4101066
15 x 1,5	4101067
16 x 2	4101068
18 x 2	4101069

Plugger

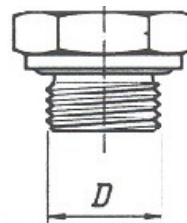

D	Best. nr.
M 12 x 1,5	4101060
M 16 x 1,5	4101061
M 22 x 1,5	4101062

Slangestusser

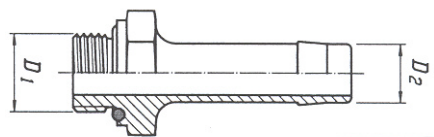

For slange Ø innv.	D1	D2	Best. nr.
9,5	M 16 x 1,5	10	4087065
9,5	M 22 x 1,5	10	4087013
11	M 16 x 1,5	12	4087055
11	M 22 x 1,5	12	4101229
13	M 16 x 1,5	14	4087059
13	M 22 x 1,5	14	4087061

T-stykker

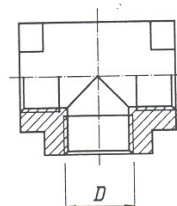

D	Best. nr.
3 x M 12 x 1,5	4100994
3 x M 16 x 1,5	4100993
3 x M 22 x 1,5	4101198

Vinkler

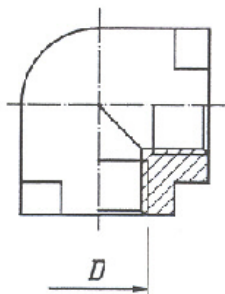

D	Best. nr.
2 x M 12 x 1,5	4101070
2 x M 16 x 1,5	4100996
2 x M 22 x 1,5	4101228

Vinkelansatser

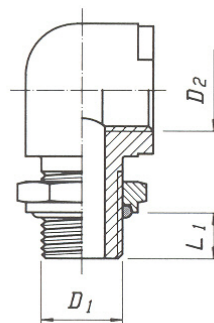

D1	D2	L1 max.	Best. nr.
M 12 x 1,5	M 12 x 1,5	11	4101098
M 14 x 1,5	M 12 x 1,5	11	4101099
M 16 x 1,5	M 12 x 1,5	11	4101100
M 14 x 1,5	M 14 x 1,5	11	4101101
M 16 x 1,5	M 16 x 1,5	11	4101102
M 22 x 1,5	M 16 x 1,5	11	4101104
M 22 x 1,5	M 22 x 1,5	11	4101106

Vinkel / rette ansatser

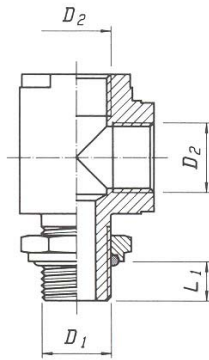

D1	D2	L1 max	Best.nr.
M 12 x 1,5	M12 x 1,5	11	4101083
M 12 x 1,5	M16 x 1,5	11	4101084
M 14 x 1,5	M 16 x 1,5	11	4101085
M 16 x 1,5	M 16 x 1,5	11	4101086
M 22 x 1,5	M 16 x 1,5	11	4101087

Kryss- ansatser

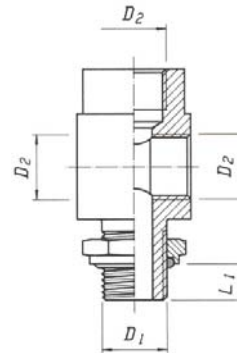

D1	D2	L1 max.	Best. nr.
M 12 x 1,5	M 12 x 1,5	11	4101088
M 16 x 1,5	M 16 x 1,5	11	4101089
M 22 x 1,5	M 16 x 1,5	11	4101090

T- ansatser

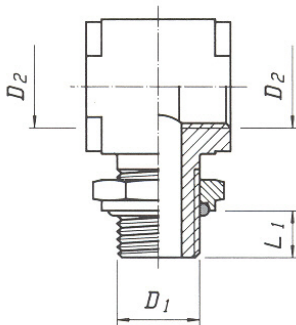

D2	D2	L1 max.	Best. nr.
M 12 x 1,5	M 12 x 1,5	11	4101091
M 14 x 1,5	M 14 x 1,5	11	4101092
M 16 x 1,5	M 16 x 1,5	11	4101095
M 22 x 1,5	M 16 x 1,5	11	4101096
M 22 x 1,5	M 22 x 1,5	11	4101097

90 ° T- ansatser

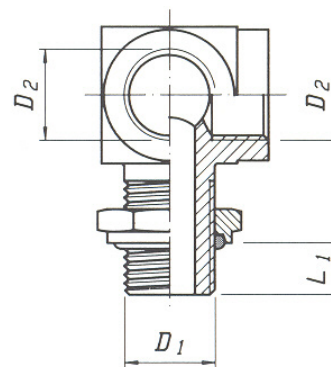

D1	D2	L1 max	Best. nr.
M 12 x 1,5	M 12 x 1,5	10	4101231
M 16 x 1,5	M 16 x 1,5	14	4101205
M 22 x 1,5	M 16 x 1,5	11	4101206

Dobbelstusser

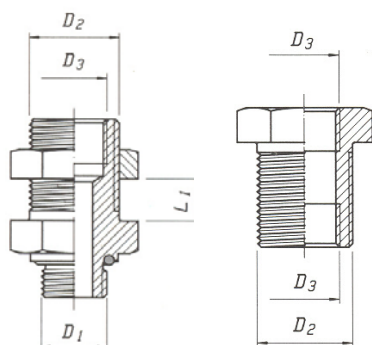

D1	D2	D3	L1 Max.	Best.
M16 x 1,5	M22 x 1,5	M16 x 1,5	16	4101017
M22 x 1,5	M22x1,5	M16 x 1,5	16	4101005
	M22x1,5	M16 x 1,5		4100992

Muttere

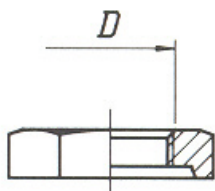

D	Best. nr.
M 16 x 1,5	1593607
M 22 x 1,5	2593601
M 22 x 1,5	75520400*

*for O-ring

Prøveuttak

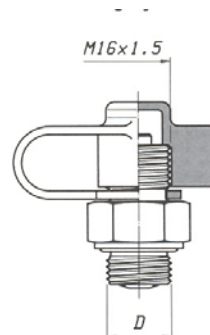

Best nr.	D
4101057	M 12 x 1,5
4101058	M 16 x 1,5
4101059	M 22 x 1,5

Vingemutter for prøveuttak



Best nr.	Innv gj.	Nippel
03-158200	M 16 x 1,5	6 mm

Kunststoffrør DIN 74324



Dim.	Rull / meter	Best nr.
Ø 6x1	15	67 0015 09
Ø 8x1	25	3-KR0810-25
Ø 9x1,5	25	3-KR0915-25
Ø 8x1	100	3-KR0810-100
Ø 10x1	25	3-KR1010-25
Ø 10x1	100	3-KR1010-100
Ø 10x1,5	25	3-KR1015-25
Ø 10x1,5	100	3-KR1015-100
Ø 11x1,5	25	3-KR1115-25
Ø 12x1,5	25	3-KR1215-25
Ø 12x1,5	100	3-KR1215-100
Ø 12x2	25	3-KR1220-25
Ø 14x2	25	3-KR1420-25
Ø 15x1,5	25	3-KR1515-25
Ø 15x1,5	100	3-KR1515-100
Ø 16x2	25	3-KR1620-25
Ø 18x2	25	3-KR1820-25

Bremseklanger

Best. nr.	Dimensjon
65 0000 09	Ø 9,5 x 19,5
65 0002 09	Ø ½" x 21
65 0001 09	Ø 14,5 x 23

Spiralslanger

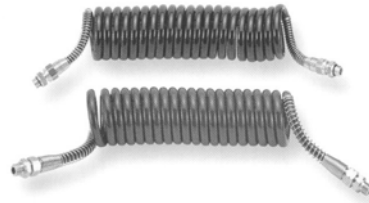

Best nr.	Farge	Tilslutn.	Utv. Ø	
03-071	Gul	M16x1,5	110	
03-072	Rød	M16x1,5	110	
03-075	Gul	M22x1,5	110	
03-076	Rød	M22x1,5	110	
03-079	Gul	M16x1,5	110	
03-080	Rød	M16x1,5	110	
03-083	Gul	M22x1,5	110	
03-084	Rød	M22x1,5	110	
5-PU5521G16	Gul	M16x1,5	80	Myk
5-PU5521R16	Rød	M16,1,5	80	Myk

Rørtang for kunststoffrør



Best. nr. tang	Reserveblad
03-120	03-121