

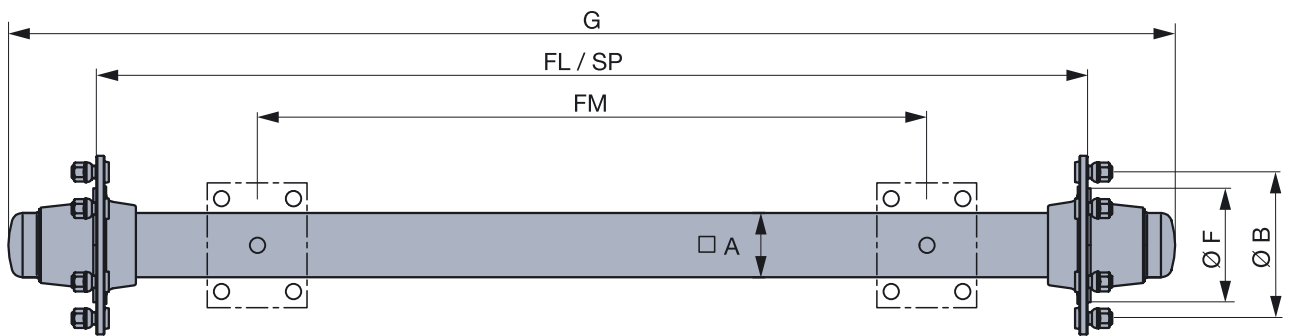

BPW trailer axles



Axle type	Track SP/FL mm	Spring centre FM mm	Overall length G mm	Axle cross section A mm	Wheel bearing designation outer/inner	Number of wheel studs	Wheel connection				kg
							ø F mm	ø B mm	Thread	BPW order no.	
GB 2305*	1500**	1000	1569	50	30205-32007x	5	62	112	M 14x1,5	55.39.001.000	43
GS 2306	1500	1000	1652	50	30205-32007x	6	160	205	M 18x1,5	55.39.001.001	44
GS 3606	1500	1000	1670	55	30206-30209	6	160	205	M 18x1,5	55.53.001.000	45
GS 4006	1500	1000	1707	60	32207-30210	6	160	205	M 18x1,5	55.56.001.000	63
GS 5506	1800	1300	2010	70	32207-32013x	6	160	205	M 18x1,5	55.63.001.008	78
GS 7008	1800	1200	2060	80	30210-32014x	8	220	275	M 20x1,5	55.67.001.011	121
GS 8008-1	1800	1200	2040	90	32213-32215	8	220	275	M 20x1,5	55.70.001.004	158

* Only for wheels with offset 26 – 50 mm

** Flange dimension

Standard offset ET 0 mm

Other dimensions available on request.

Special equipment: • Spring pads



These solid and hollow axle beams with 50-150 mm axle beam cross-section can handle static axle loads of between 1,000 and 16,000 kg. High-quality reinforced bearings of western European manufacture are particularly durable and ensure the greatest possible operational reliability.

BPW trailer axle stub

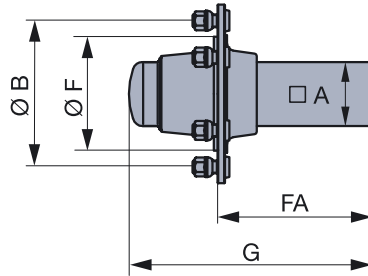

Axle stub type	Overall length G mm	Flange clearance FA mm	Axle cross section A mm	Wheel bearing designation outer/inner	Number of wheel studs	Wheel connection				kg
						ø F mm	ø B mm	Thread	BPW order no.	
GBST 2305*	312	200	50	30205-32007x	5	62	112	M 14x1,5	58.39.001.000	7
GSST 2306	312	200	50	30205-32007x	6	160	205	M 18x1,5	58.39.001.001	8
GSST 3606	337	200	55	30206-30209	6	160	205	M 18x1,5	58.53.001.000	10
GSST 4006	357	200	60	32207-30210	6	160	205	M 18x1,5	58.56.001.000	15
GSST 5506	353	200	70	32207-32013x	6	160	205	M 18x1,5	58.63.001.000	18
GSST 7008	380	200	80	30210-32014x	8	220	275	M 20x1,5	58.67.001.001	28
GSST 8008-1	378	200	90	32213-32215	8	220	275	M 20x1,5	58.70.001.016	47

* Only for wheels with offset 26 – 50 mm

Standard offset ET 0 mm

Other dimensions available on request.

Special equipment: • Spring pads